



STEP System

(Effluent Pump Basin Package)

SS-300

Features

- Ideal for repairs and sites with limited space
- Small lift station may be used to provide small doses to a disposal field
- Includes all components required to install a pump outside a tank
- Additional risers may be added for deeper installations (50" max)
- Includes 1/3 hp effluent pump

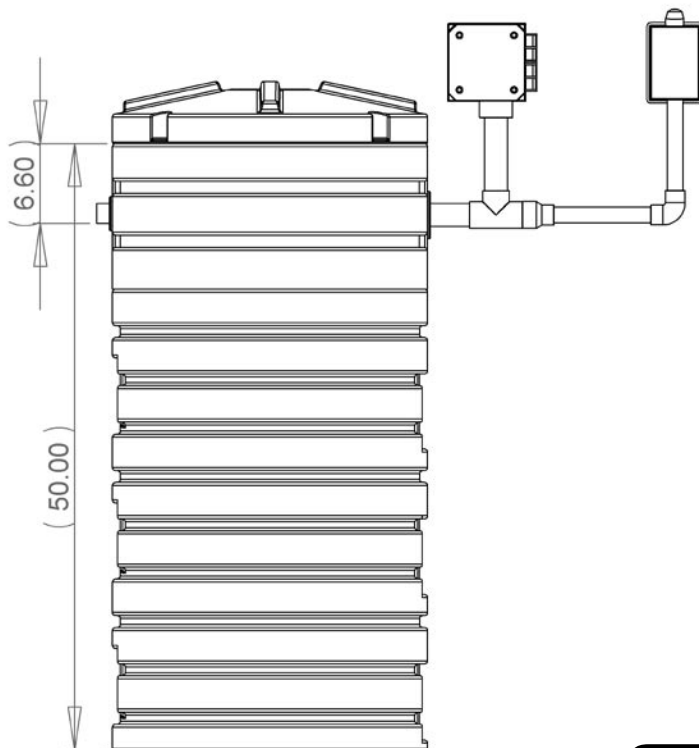
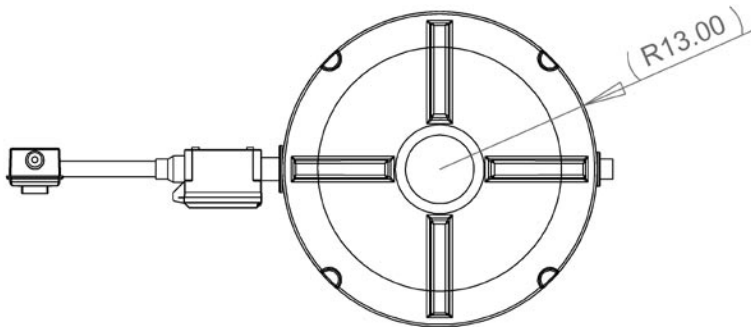
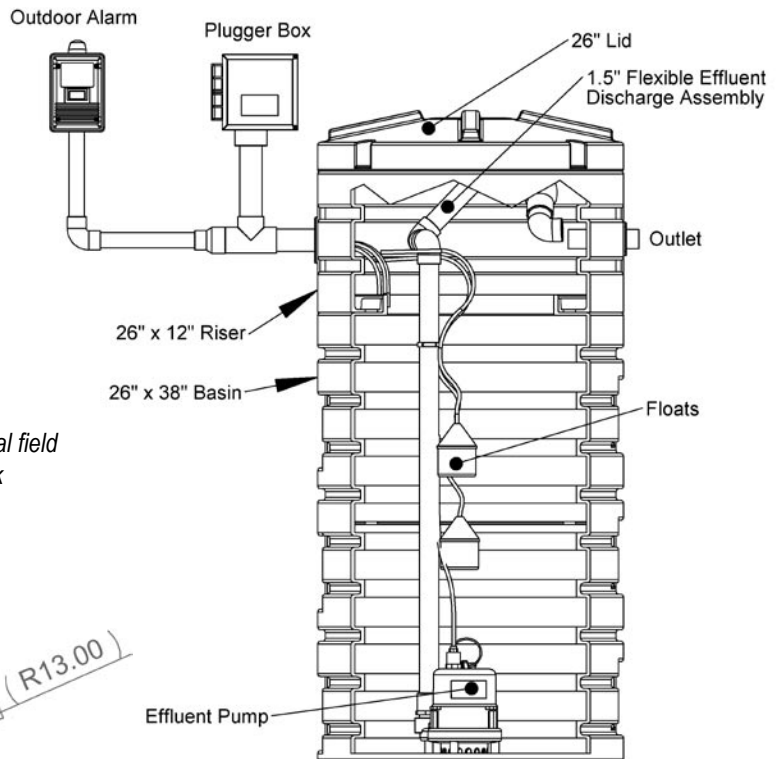

Components

- **RB-B-26x38:** 26" x 38" basin
- **RB-R-26x12:** 26" x 12" riser
- **RB-L-26:** 26" lid
- **P-SE-13T:** 1/3 hp submersible effluent pump
- **PDS-EDF-1.50:** 1.50" flexible effluent discharge
- **PDS-GT-1.50:** 1.50" water-tight grommet
- **PDS-GT-4.0:** 4" water-tight grommet
- **AC-JPB:** Junction plug box
- **AC-A-O:** Indoor/outdoor high water alarm

Warranty for Defects in Material and Workmanship

- **Pump - 3 Years**
- **Alarms/controls - 3 Years**
- **Basin, riser and lid - 2 Years**
- **All other components - 1 Year**

AutoCad files at www.quanics.net

1-877-QUANICS - www.quanics.net



© 2007, Quanics Inc. All rights reserved.
Product(s) covered by one or more U.S.
and/or International patents. Other U.S. and
International patents may be pending.

