

Alarms & Controls Float Switches

AC-PMS

Features:

- Mechanically-activated pump switch
- Adjustable pumping range of 7 to 36 inches

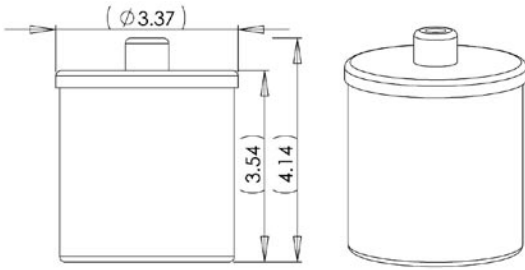

Specifications

Cable

- 15' flexible 16 gauge, 2 conductor (UL, CSA) SJOW

Float

- High impact, corrosion resistant PVC

Electrical

- 120 VAC 50/60 Hz single phase, 1/2 HP or less recommended pump HP
- 230 VAC 50/60 Hz single phase, 1 HP or less recommended pump HP

Note: this switch must be used with pumps that provide integral thermal overload protection

AC-MFS

Features:

- Mercury activated control switch
- Control differential of .5 inches above or below horizontal

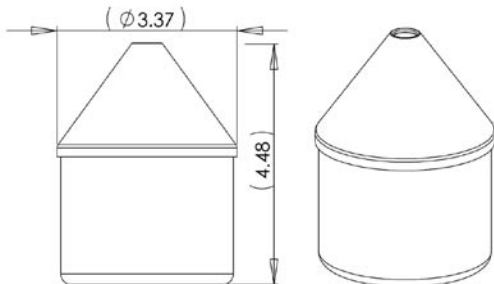

Specifications

Cable

- 15' flexible 18 gauge, 2 conductor (UL, CSA) SJOW

Float

- High impact, corrosion resistant PVC

Maximum water depth

- 30 feet, 13 psi

Mercury tilt switch

- Single pole, single throw, mercury to mercury contacts

Electrical

- 5 amp, 120/230 VAC, 50/60 Hz

Pricing Page 5

AC-VMS

Features:

- Mechanically-activated pump switch
- Adjustable pumping range of .75 to 6.5 inches

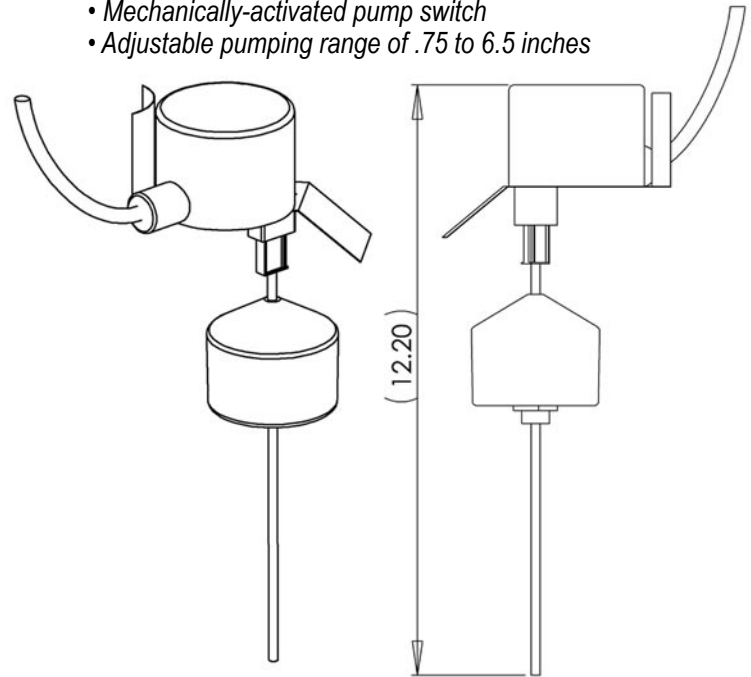

Specifications

- Cable - 10' flexible 16 gauge, 2 conductor (UL, CSA) SJOW

Float assembly

- Mounting bracket & hose clamp - stainless steel
- Lift rod - injection molded acetal plastic
- Float stop - neoprene

Switch and float housing - High impact, corrosion resistant PVC

Electrical

- 120 VAC 50/60 Hz single phase; 13 amp max. pump running current; 60 amp max. pump starting current
- 230 VAC 50/60 Hz single phase; 12 amp max. pump running current; 60 amp max. pump starting current

Note: this switch must be used with pumps that provide integral thermal overload protection

Warranty for Defects in Material and Workmanship

- 1 Year on all floats

1-877-QUANICS - www.quanics.net

Quanics
Engineering Water Solutions®

© 2007, Quanics Inc. All rights reserved.
Product(s) covered by one or more U.S.
and/or International patents. Other U.S. and
International patents may be pending.

DOWNLOAD
AutoCAD
DRAWINGS